

Light data

Luminous flux
2,000 lm

Tunable white
2,200–4,000 K

Beam angle
120°

Dimming
0.1–100 %

Ra
93

SDCM
3

L70/B50
100,000 h
Ta 35 °C

Light source
LED (non user replaceable)

Technical data

IP rating
Ceiling: IP44
Wall: IP20

Protection class
Class II

Impact resistance
IK07

Protection

Overtemperature protection

Operating environment
Indoor

Permissible ambient temperature
-25 to +35 °C

Battery backup
Battery life up to 10 years

Maximum power consumption
22 W

Energy efficiency class
F

Mains electricity
230 V~ 50 Hz

Power factor (PF)
0.9

Standby power
Psb, Pnet: 0.20 W

Maximum bypass current
16 A

Cable area
0.75–2.5 mm²

Radio

2.4 GHz mesh
Bluetooth®
<10 dBm

Radio range:
Approx. 10 m.

The Plejd mesh technology extends the range by allowing the units to communicate with each other.

CCL-01-S

Motion sensor*

PIR Sensor (Infrared sensor)
HF Sensor (Doppler radar)

Range (PIR Sensor)

Mounted at 2.5 m: 5 m
detection radius (up to 10 m
tangential movement).

Mounted at 3 m: 6 m
detection radius (up to 11 m
tangential movement).

(According to IEC 63180)

Range (HF Sensor)

Adjustable up to 10 m (minor
motion).

Daylight sensor

Activate only in low light.

Radio

5.8 GHz radar

*The sensors work together
for improved motion
detection.

1145.1.1

RISK OF INJURY TO PERSON OR PROPERTY

All work on the appliance must be carried out by an authorized electrician. National laws and regulations must be followed.

Declaration of conformity

Hereby, Plejd AB declares that the radio equipment type CCL-01 is in compliance with Directive 2014/53/EU.

The full text of the EU declaration of conformity and third-party licenses are available at the following internet address: plejd.com/compliance



Important information

Do not use the product if it has visible signs of damage.

The light source must only be replaced by the manufacturer or qualified service agent.



Disposal and recycling

This electrical product should not be disposed of together with other household waste. Contact your local recycling center for guidance on electrical and electronic equipment disposal.



CCL-01 & CCL-01-S INSTALLATION MANUAL

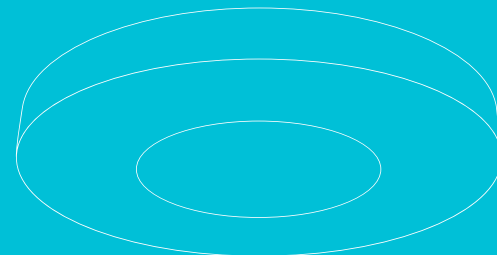

Further information can be found
in the **Plejd** app or at plejd.com

NOTE! Do not wire to dimmer.
Dimmer is built-in.

Make sure to **shut off the main power** before installing the CCL-01.



Do not cut cable grommet. The IP rating is only valid when they are undamaged.

Install the product

Step 1. Open the lid with a flat tool by bending carefully.

Step 2. The lid can be locked in an upright position.

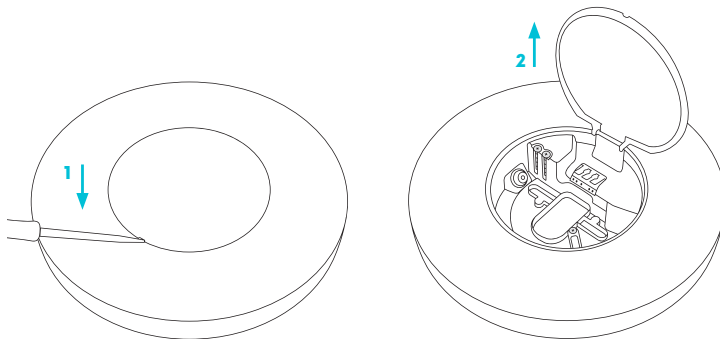

Step 3. CCL-01 can be installed on all hard surfaces, such as wood, concrete, and drywall. Use screws suited for the surface. Two M4 screws are included to be used with ceiling junction box.

Pull the supply cable through one of the cable openings, then mount CCL-01. Choose mounting holes based on centre-to-centre distance and screw size.

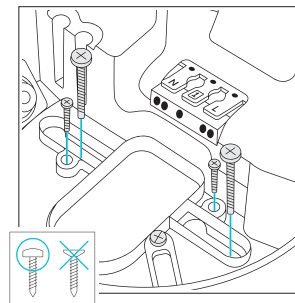
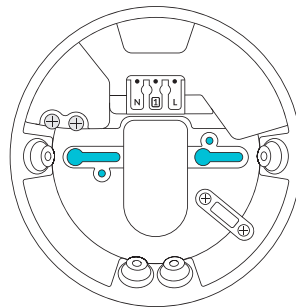
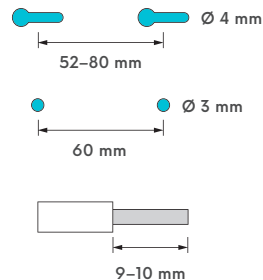

Step 4. Connect live (L) and neutral (N) wires. Control input 1 can be used for control with push button (preset), light switch, or motion sensor (with neutral conductor).

The input can also be used to wirelessly control one or more products from Plejd.

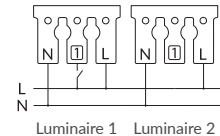

NOTE! Do not connect input 1 between several products. Use the app to configure the control and connection of several devices in a group.

Follow the instructions in the app

Download the Plejd app on the App Store or Google Play. Use the app to complete the installation and group your light fixtures. Setup requires Bluetooth® and an internet connection.

Hand over the Plejd system

Once you have completed the installation, you will find the system code in the app. Write the code on the included sticker. Place the sticker in the distribution box and give the welcome folder **Hi!** to the customer.

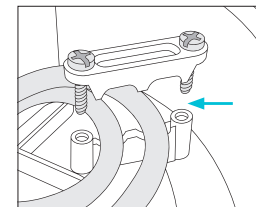

NOTE! Secure with cord anchorage when installing with cable. Use cables with the same diameter.