

# rotronic

Datenblatt - Fiche technique - Data sheet

21.17.3066



**ROLINE Junction Box Kat. 6, UTP,**

**ROLINE Module de liaison Cat.6, UTP,**

**ROLINE Junction Box Cat.6, UTP,**

**Cat.6 Junction Box**

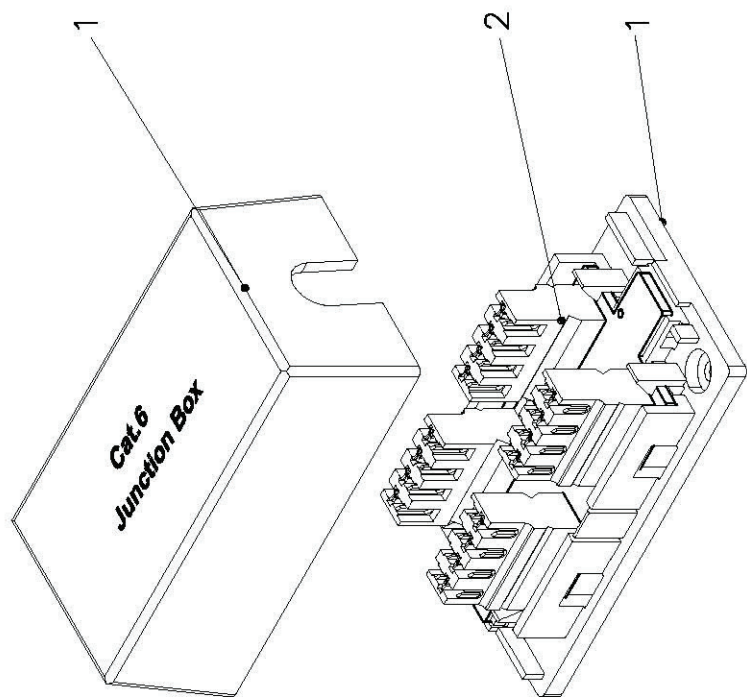
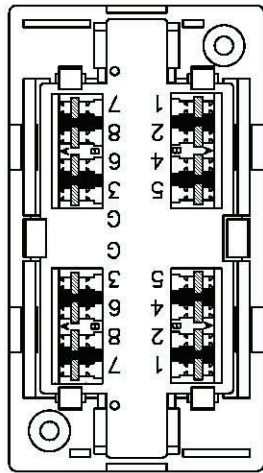
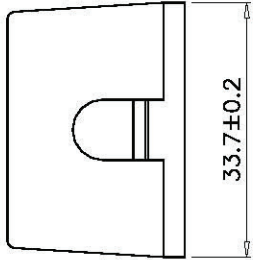
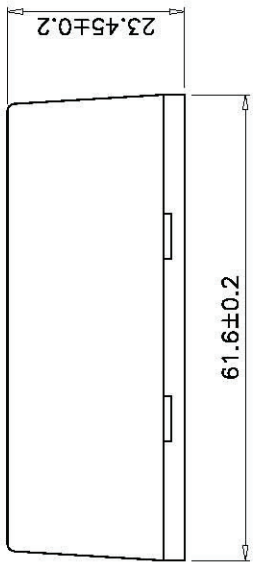
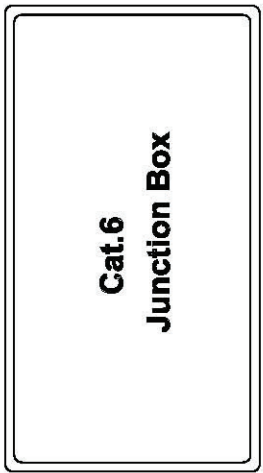

SCALE 1/1

**Specification :**

- Material :**
1. Box : ABS, UL 94V-0, with white color.
  2. IDC :
  - 2-1. Housing : PC+Glass Fiber, UL 94V-2.
  - 2-2. Phosphor Bronze with Tin plated.
  3. PCB : FR4, UL 94V-0.

- Performance :**
- a. T568A & T568B wiring.
  - b. Operating temperature : -10°C to 60°C.(ISO/IEC 11801, ANSI/TIA/EIA 568 B.2)
  - c. Durability :
    - \*IDC : Suitable for 22-26 AWG stranded and solid wire, compatible with both 110 & Krone punch down tools.
  - d. The Cat.6 transmission performance is in compliance with the ANSI/TIA/EIA 568 B.2-1 standard.

NO.	DESCRIPTION	P/N.	MATERIAL	Q'TY
	DRAWING	05.JUN.2013	YAN	
	CHECK	05.JUN.2013	MAER	
	APPROVAL	05.JUN.2013	FRANK	
	SCALE	1/1 (A4)	UNIT mm	
	DATE		NAME	
	DRAWING NO.		ITEM NO.:	21.17.3066
	ROLINE CAT.6 JUNCTION BOX, UNSHIELDED			
	DRAWING CLASSIFICATION S SHEET 1 OF 1			

No.	MODIFIED AREA	ORIGINAL	MODIFY	DATE	MODIFIER

**rotronic**

GENERAL TOLERANCE OF DIMENSIONS  
 X.XXX ±0.005  
 X.XX ±0.05  
 X.X ±0.1

10cm